



8TH
WORLD KUNGFU CHAMPIONSHIPS

REGULATIONS

JUNE
14-19, 2019



EMEISHAN, SICHUAN
CHINA



*Mr. Yu Zaiqing
President, International Wushu Federation (IWUF)
Vice President, International Olympic Committee (IOC)*

Dear Members,

I cordially invite you to join wushu enthusiasts from all corners of the globe at the 8th World Kungfu Championships that will take place Emeishan, China beginning on June 14, 2019.

The World Kungfu Championships (WKFC), hosted by the IWUF, is an international-level sporting event established in 2004 to propagate the development of wushu around the world. As there are dozens of kungfu (traditional wushu) styles represented in the WKFC, these championships offer a unique platform for thousands of practitioners of all ages and varying skill levels to come together every two years. At the WKFC, mutual understanding is fostered through skill and cultural exchanges. In the spirit of sport, growth, development, and health are the core values of the event. The World Kungfu Championships provides a festive foundation for building connections and nurturing passion for the practice of wushu.

The 8th World Kungfu Championships (8th WKFC) will be held in Emeishan, Sichuan, China, from June 14th to June 19th, 2019, and will feature hundreds of events for the 3000+ participants to take part in. The 8th WKFC will also host the second edition of the Seminar Programme, providing exclusive opportunities to listen to and learn from kungfu masters and experts. Those attending the Championships will find a uniquely festive atmosphere, a chance to learn and celebrate together.

I thank you in advance for your support, and look forward to your participation in Emeishan!

A handwritten signature in black ink, consisting of stylized Chinese characters, likely reading 'Yu Zaiqing'.

CONTENTS

I.	INTRODUCTION	01
II.	GENERAL PROGRAM	02
III.	GENERAL INFORMATION	03
IV.	DATES	04
V.	VENUES	04
VI.	COMPETITION EVENTS	05
VII.	QUALIFICATION	06
VIII.	PARTICIPATION METHODS	07
IX.	COMPETITION RULES	08
X.	UNIFORMS & EQUIPMENTS	08
XI.	PLACING & AWARDS	09
XII.	REGISTRATION	11
XIII.	ARRIVAL & ACCREDITATION	12
XIV.	TECHNICAL MEETING	14
XV.	TECHNICAL OFFICIALS & JURY OF APPEALS	14
XVI.	ACCOMMODATION	15
XVII.	TRANSPORTATION - ARRIVAL	16
XVIII.	FINANCIAL INFORMATION	16
XIX.	PASSPORTS & VISA REQUIREMENTS	18
XX.	RESPONSIBILITY OF NATIONAL FEDERATIONS	18
XXI.	SEMINAR PROGRAMME	19
XXII.	APPENDIX	19

I. INTRODUCTION

The World Kungfu Championships (WKFC), hosted by the IWUF, is an international level sporting event established in 2004 to propagate the development of wushu around the world. As there are dozens of kungfu (traditional wushu) styles represented in the WKFC, these championships offer a unique platform for thousands of practitioners of all ages and varying skill levels to come together every two years. At the WKFC, mutual understanding is fostered through skill and cultural exchanges. In the spirit of sport, growth, development, and health are the core values of the event. The World Kungfu Championships provides a festive foundation for building connections and nurturing passion for the practice of wushu.

The 8th World Kungfu Championships (8th WKFC) will be held in Emeishan, Sichuan, China, from June 14th to June 19th, 2019, and will feature hundreds of events for the 3000+ participants to take part in. The 8th WKFC will also host the second edition of the Seminar Programme, providing exclusive opportunities to listen to and learn from kungfu masters and experts. The city of Emeishan, with the support of the Chinese Wushu Association, is responsible for organizing the 8th WKFC under the auspices of the IWUF.

II. GENERAL PROGRAM

Date	Time	Content	Location
June 14	Full Day	Team Registration	Hotels
		Referee Registration	Heng Mai Hotel
June 15	09:30	Technical Meeting	Heng Mai Hotel
	Full Day	Judges’ Refresher Course	Heng Mai Hotel
		Athlete Training	Sichuan International Tourism and Trading Expo Center
	18:00	Welcome Dinner	Heng Mai Hotel (by invitation only)
June 16	08:30	Opening Ceremony	Sichuan International Tourism and Trading Expo Center
	09:00-11:30	Competition	
	14:30-17:30	Competition	
June 17	09:00-11:30	Competition	Sichuan International Tourism and Trading Expo Center
	14:30-17:30	Competition	
June 18	09:00-11:30	Competition	Sichuan International Tourism and Trading Expo Center
	14:30-17:30	1. Competition 2. Closing Ceremony	
June 19	Departure		

III. GENERAL INFORMATION

A. General Contacts

IWUF Secretariat

Telephone: +86-10-87774492

Email: iwuf@iwuf.org

Add.: Huaweili 9, Chaoyang District, Beijing 100021, China

Organizing Committee of 8th World Kungfu Championships (LOC)

Contact: Liu Wei / Su Ya

Telephone: +86 (138) 80059676 / +86 (187) 80105473

Email: 1920978160@qq.com

B. Emeishan at a Glance

Emeishan City, Sichuan Province is a city with a vibrant population of 433,000 and home to Mount Emei (“Emeishan”), one of the four famous Buddhist Mountains in China. Emeishan City is located approximately 140 km to the southeast of Sichuan’s capital city Chengdu, and over its long history the city has come to be known for its deep cultural significance. It is listed as a World Heritage Site by UNESCO for both its cultural significance and natural heritage. With temples, hiking trails, hot springs, and breathtaking scenery, Emeishan has much to offer both the casual and adventurous traveler.

Emeishan also has a deep association with kungfu, with traditional styles being practiced there for centuries. This passion for kungfu continues to flourish in modern times, adding another dimension of excitement and relevance for the city in hosting the 8th WKFC.

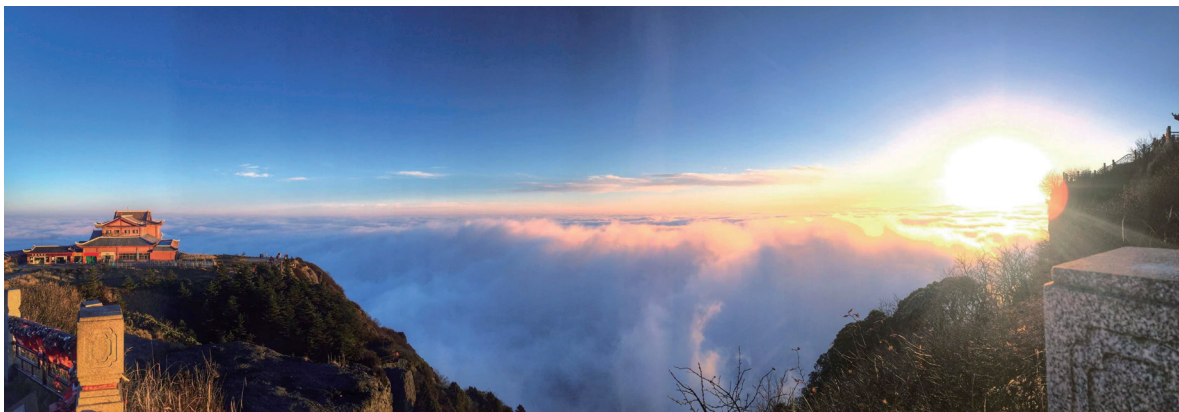

C. International Airports

Chengdu Shuangliu International Airport (Code: CTU-ZUUU)

Chengdu City, Sichuan Province, China

D. Weather

Historical average temperatures for Emeishan in June range from 7°-13°C (44°-55°F).

E. Currency

The Chinese currency is the Yuan (CNY), abbreviated as RMB. The RMB/USD exchange rate is approximately ¥1/US\$0.15, or US\$1/¥6.89.

F. Electricity

The Chinese electricity standard is 220 volts/50 Hz.

G. Telephones

To call Emeishan numbers from abroad, dial +86 (or your country's international exit code followed by (86)), then Emeishan's area code (833), followed by the local number.

IV. DATES

Competition Dates	Final Entry Deadline
2019.06.16-2019.06.18	2019.04.30

V. VENUES

A. Venue Introduction

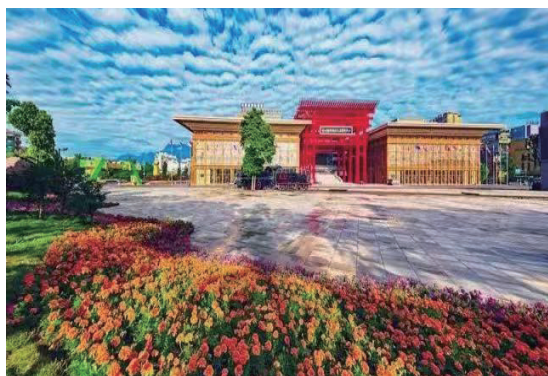

Sichuan International Tourism Trade Expo Center covers a total structure area of 48 thousand square meters and plans to allocate over 10 thousand square meters as the site for Championships competitions and related activities.

B. Training Venue

Sichuan International Tourism and Trading Expo Center

C. Competitions Venue

Sichuan International Tourism and Trading Expo Center

VI. COMPETITION EVENTS

A. Individual Events

i. Individual Bare Hand Routine Events

- a. Taijiquan-type Events: Chen Style, Yang Style, Wu Style, Wu Style, Sun Style, other traditional Taijiquan routines. Compulsory routines of Chen, Yang, Wu, Wu, Sun, and 42-posture Taijiquan are classified as traditional events.
- b. Nanquan-type Events: Wing Chun (Yongchun Quan), Ngo Cho (Wuzu Quan), Choy Lay Fut (Cailifo Quan), Hung Gar (Hongjia Quan), Dishu Quan, other southern styles.
- c. Other Style Events: Xingyi Quan, Bagua Zhang, Baji Quan, Tongbei Quan, Pigua Quan (Zhang), Fanzi Quan, Ditang Quan, Imitation styles, Cha Quan, Hua Quan, Pao Chui, Hong Quan, Shaolin Quan, Wudang Quan, Emei Quan, other types of traditional styles.

ii. Individual Weapon Routine Events

- a. Single-weapon Routines: Dao (Broadsword), Jian (Straight Sword), Gun (Cudgel/Staff), Qiang (Spear), Pudaο, Guandao (Kwan Dao), Fan, Dagger, Bain Gun (Short Cudgel), Cane, Baton, Crutch (Chinese Tonfa), Spade, Fork, Taiji Jian (Including 42-posture Taiji Jian), Taiji Dao, Taiji Qiang, Nan Dao (Southern Broadsword), Nan Gun (Southern Staff/Cudgel), other traditional single-weapon routines.

- b. Double-weapon Routines: Shuang Dao (Double Broadsword), Shuang Jian (Double Straight Sword/ Double Long Tassel Straight Sword), Shuang Gou (Double Tiger Hooks), Double Daggers, Shuang Yue (Bagua Double Deer Horn Knives), other traditional double-weapon routines.
- c. Flexible/Soft-weapon Routines: Jiu Jie Bian (Nine Section Whip Chain), San Jie Gun (Three Section Staff), Meteor Hammer, Rope Dart, other traditional flexible/soft-weapon routines.

B. Duilian (Choreographed Sparring) Routine Events

- i. Bare Hand vs. Bare Hand Routine
- ii. Bare Hand vs. Weapon Routine
- iii. Weapon vs. Weapon Routine

C. Group Routine Events

- i. Single Style Bare Hand Group Routine
- ii. Single Type Weapon Group Routine

VII. QUALIFICATION

A. Membership

- i. Only those federations/associations which have paid their IWUF annual membership fees for 2018 and 2019 will be permitted to participate in the 8th WKFC.
- ii. New IWUF member federations may be invited to take part in the 8th WKFC after their membership applications have been accepted by the IWUF.
- iii. Participants from countries that do not have an IWUF-recognized member federation may participate, subject to IWUF approval.

B. Nationality

- i. Athletes must be citizens or permanent residents of the country that they are representing.
- ii. Athletes who have dual citizenship can only represent one (1) country in the championships.

C. Age Requirements

- i. Group A: Under the age of 8 (born on or after January 1, 2012);
- ii. Group B: Ages 8 to 11 (born between January 1, 2008 and December 31, 2011);
- iii. Group C: Ages 12 to 17 (born between January 1, 2002 and December 31, 2007);
- iv. Group D: Ages 18 to 39 (born between January 1, 1980 and December 31, 2001);
- v. Group E: Ages 40 to 59 (born between January 1, 1960 and December 31, 1979);
- vi. Group F: Ages 60 and above (born on or before December 31, 1959).

VIII. PARTICIPATION METHODS

A. Team Composition

- i. Each member federation can enter at most one (1) Team, hereinafter is referred to as “Team”.
- ii. Each Team shall comprise of Team members of the following roles:
 - One (1) Team leader**
 - One (1) Team coach**
 - One (1) Team doctor**
 - Athletes (the number of athletes permitted is not limited)**
- iii. Each athlete may, at most, register to participate in:
 - One (1) individual bare hand routine**
 - One (1) individual weapon routine**
 - One (1) duilian (choreographed sparring) routine**
 - One (1) group routine**
- iv. Each Team may at most register one (1) duilian (choreographed sparring) routine, comprising of at most three (3) people (male and female athletes may be mixed).
- v. Each Team may at most register one (1) group routine. The genders and ages of the athletes within this group are not limited. Each group must comprise of at least six (6) athletes.

IX. COMPETITION RULES

A. Competition Rules and Judging Methods

- i. Unless otherwise stated within these regulations, the competition will be conducted in accordance with the:
 - 2019 IWUF “Traditional Wushu Competition Rules and Judging Methods (Trial)”.
- ii. The Rules and Methods may be interpreted solely at the discretion the IWUF. In the event of language discrepancies in the “Rules” and “Methods”, the English text shall prevail.

B. Events Time Requirement

- i. The events time requirement shall be subject to the relevant provisions of 2019 IWUF “Traditional Wushu Competition Rules and Judging Methods (Trial)”.
- ii. For compulsory taijiquan and compulsory taiji weapon routines, there will be no point deductions for the omission of set techniques.
- iii. Accompanying music is required for group routines, and must be provided by the athletes themselves on a CD or a USB flash drive. Accompanying music may not include vocals of any form. Should accompanying music include vocals, or should no accompanying music be provided, the head judge will deduct 0.1 points.

X. UNIFORMS & EQUIPMENTS

A. Uniform and Equipment Requirements and Procedures

- i. Competition Requirements
 - a. All athletes shall wear wushu competition uniforms in compliance with the rules during all events. All athletes must provide their own uniform.
 - b. All weaponry must conform to the requirements as stipulated in the Rules. All athletes must provide their own weaponry.

ii. Clothing Requirements for Opening/Closing Ceremony

- a. All Teams must wear their official national/regional Team uniforms at the Opening and Closing Ceremonies.

iii. Clothing Requirements for Awards Ceremony

- a. Medalists are expected to attend the Awards Ceremony in their national Team uniforms; however, they are permitted to wear competition uniforms should the ceremony take place immediately after the competition.
- b. Athletes are expected to take off caps/hats during the ceremony.
- c. Athletes and officials are not allowed to take any religious symbols to the podium.

iv. Compliance Check at Roll Call Center

- a. All athletes are required to attend the initial roll call thirty (30) minutes prior to the start of their competition event and be present for all subsequent roll calls. Failure to be present for three (3) roll calls will result in forfeit.

XI. PLACING & AWARDS

A. Placing & Awards

- i. In general, each individual event within each age group (for male and female) will be awarded as follows:
 - a. 1st Category Prize = Awarded to 10% of the athletes (Top 20% will be awarded for age group A, B & F).
 - b. 2nd Category Prize = Awarded to 20% of the athletes.
 - c. 3rd Category Prize = Awarded to 30% of the athletes.

- 1st, 2nd, and 3rd Category Prize recipients will receive a medal and certificate. Other athletes will receive a participation certificate. The awarding ratios will be based on the actual number of athletes in an event and a rounding method will be implemented.
- ii. Duilian events will be separated into two (2)-person and three (3)-person performances, bare hand performances, and weapon performances. The above awards ratios will apply.
 - iii. Group routines will be separated into bare hand group routines and weapon group routines (group routines mixing bare hand and weapons will be categorized as weapon routines) and will be awarded as follows:
 - a. 1st Category Prize = Awarded to 20% of the Groups.
 - b. 2nd Category Prize = Awarded to 30% of the Groups.
 - c. 3rd Category Prize = Awarded to 30% of the Groups.
- 1st, 2nd, and 3rd Category Prize recipients will receive a plaque and certificate. The awarding ratios will be based on the actual number of Groups in an event and a rounding method will be implemented.
- iv. For individual events, within each age group, for male and female, in which the total number of registered athletes is five (5) people or fewer, these events may be combined. Characteristic similarity of the styles, ages, etc. will be considered when events are combined.
 - v. For individual events, within each age group, for male and female, in which the total number of registered athletes is six (6) people or more, these events will be individual style/routine events with awarding in accordance with the above guidelines.
 - vi. Each event will be limited to sixty (60) athletes. If the number of registered athletes for a particular discipline exceeds sixty (60), athletes for that event will be randomly and evenly divided into two or more groups.

B. Awards Ceremony

- i. Athletes having won a medal are required to attend the Awards Ceremony to receive their medals in person. In case a medalist is unable to attend the ceremony for a valid reason, his/her medal may be presented to an official of the relevant Team. If an athlete is absent during the Awards Ceremony without valid reason, he/she will be forfeited the right to receive his/her medal.

- ii. Team leaders, coaches, doctors, observers, and members must stay at the designated area and are prohibited from entering the awarding platform area and/or interrupting the Awards Ceremony.
- iii. If fewer than three athletes participate in a given event, no Awards Ceremony will be held for that event (athletes will still be ranked and receive awards accordingly).

C. Participation Certificate

- i. All members of each Team, including Team leaders, coaches, doctors, and athletes will receive an 8th WKFC participation certificate.
- ii. The Team leader is must collect their Team's participation certificates from the Organizing Committee at the designated Result & Certificate Center.

XII. REGISTRATION

A. Final Entry - 24:00 on April 30, 2019

- i. All final entries must be submitted through the IWUF Online Registration System **<http://justtool.com/iwuf>**. All sections of the online entry must be completed in full, including the uploading of the fully completed and signed waiver of liabilities for each participant.
- ii. Those teams/participants from countries/regions which do not have IWUF member federations/associations must contact the IWUF regarding registration methods.
- iii. The deadline for final entry submission through the online system is 24:00 (Beijing Standard Time) on **April 30, 2019**. Each Team is required to print a copy of the submitted entry and present it during accreditation upon arrival in Emeishan.

IWUF Online Registration System URL: <http://justtool.com/iwuf>

Email: wushu@justtool.com

Tel: +86-757 83991970

Fax: +86-757 83991970

iv. Post-deadline Entries or Changes

- a. After the final entry deadline, any request to change the entry (including late entry) will be handled as follows:
- Late entries are subject to the approval of the IWUF and, if accepted, are subject to a late-entry fee of US\$ 50 per participant.
 - Replacing a participant is subject to approval by the IWUF and, if accepted, is subject to a replacement fee of US\$ 50 per participant.
 - If changes are required due to incorrect or missing registration information, those changes are subject to approval by the IWUF and if accepted, a fee of US\$ 20 per change will be charged.
 - The above fees must be paid in cash to the IWUF Secretariat before the Opening Ceremony.

Late Entry	Replacement	Information Change
US\$ 50	US\$ 50	US\$ 20

XIII. ARRIVAL & ACCREDITATION

A. Arrival

- All Teams are required to check in at the designated Accreditation Center and register with the 8th WKFC Organizing Committee no later than 24:00 (Beijing Standard Time) on **June 14, 2019**.
- All judges are required to register at the designated Accreditation Center and register with the 8th WKFC Organizing Committee no later than 24:00 (Beijing Standard Time) on **June 13, 2019**.
- Hotel check-in is after 15:00, and accommodations should be booked accordingly (e.g. Teams wishing check in on June 15 before 15:00 must have booked their accommodations beginning on June 14).

B. Accreditation

- The Accreditation Center(s) will open at 09:00 on **June 13, 2019**.

- ii. All participating Teams are required to submit their full and final arrival and departure flight details through the IWUF online registration system at the same time as their final entries.
- iii. Following arrival, the organizing committee's medical supervisor has the right to check the athlete's physical health condition and should it be deemed that an athlete is not healthy or fit to compete, his or her participation eligibility will be cancelled.
- iv. Following arrival, all Teams are requested to carefully check the competition event draw and order lists. Should there be any objections regarding the competition events, participant names, the participant in question or the designated Team leader must complete and submit the signed relevant correction form to the organizing committee before 09:30 on the **15th of June 2019**. The Chief Scheduler/Recorder will check the original submitted registration and should there be a discrepancy between the two, the information will be amended.
- v. Upon arrival at the Accreditation Center, the Team leader is required to complete the following process with the Organizing Committee:

1	Present each Team member's passport
2	Submit a paper copy of a signed and stamped Final Entry Form and confirm the registration information
3	Submit three (3) national/regional flags (Size: 1 m*2 m)
4	Submit national anthem (short version) in MP3 format on a CD or USB flash drive
5	Submit three (3) color photos (passport size) per Team member
6	Submit valid life and liability insurance certificates
7	Submit the signed Wavier of Liabilities (Appendix 1)
8	Pay the relevant participation fees in full (if applicable)
9	Pay the relevant penalty fees in full (if applicable)
10	Confirm and sign the above items

- vi. Accreditation cards will be given to the Team leader upon completion of accreditation process. Accreditation cards must be worn during all official 8th WKFC events.

vii. The training schedule will be announced after accreditation has concluded.

XIV. TECHNICAL MEETING

The Technical Meeting will take place on **June 15th, 2019**. Each Team should send one to three (1-3) representatives to attend the meeting.

The Technical Meeting content will be presented as follows:

- IWUF Opening Remarks and Event Guidelines (IWUF representatives)
- Event Logistics Information (Organizing Committee representatives)
- Event Technical Details (IWUF Technical Committee representatives)
- Other matters

XV. TECHNICAL OFFICIALS & JURY OF APPEALS

A. Judges (Referees)

All judges will be appointed by the IWUF.

i. Judges' Refresher Course

All 8th WKFC judges are required to participate in the Judges' Refresher Course. The purpose of this course is to ensure that judges have a solid understanding and grasp of competition rules, to enhance transparency and objectivity in judging.

ii. Judges' Uniform Requirements

All judges shall prepare their own standard judges' uniforms, white shirts, and black leather shoes.

B. JURY OF APPEALS

The Jury of Appeals and appeals procedures shall be subject to the relevant provisions of 2019 IWUF “Traditional Wushu Competition Rules and Judging Methods (Trial)”.

XVI. ACCOMMODATION

A. Accommodation Reservation

- i. All Teams are required to reside at the designated hotels as arranged by the Organizing Committee.
- ii. The Organizing Committee will arrange accommodation and local transportation for all Teams from June 14th to June 18th, 2019. Teams that would like to arrive earlier and/or depart later than these dates should provide dates for the intended duration of stay during the final registration process. Teams must ensure to book accommodations accordingly, with daily rates applying for extended stays and taking the hotel check-in time of 15:00 into consideration (see section XIII.A.).

B. Accommodation Information

i. Official Hotel

- a. Century Sunshine Hotel ★★★★★
Address: Emeishan Mingshan East Road No. 410
Distance from venue: 1.5 km, 4 minutes by car
- b. Hongzhushan Hotel (Building No.5 & No.8) ★★★★★
Address: Left side of Baoguo Temple, Emeishan
Distance from venue: 10 km, 20 minutes by car
- c. Huasheng ★★★★★
Address: Emeishan Foguang South Road No. 400
Distance from venue: 3 km, 6 minutes by car
- d. Emei Hot Spring Hotel ★★★★★
Address: Emeishan Baoguo Temple Scenic Area, 300 meters from Tianxia Mingshan Archway on the left

- e. Emeishan Grand Hotel ★★★★★
Address: Emeishan Baoguo Temple Scenic Area Second Part No. 322
Distance from venue: 10 km, 20 minutes by car
- f. Emeishan Hengmai Hotel ★★★★★
Address: Emeishan Mingshan East Road No. 71
Distance from venue: 1 km, 2 minutes by car
- g. Emeishan Hotel ★★★
Address: Emeishan Mingshan South Road No. 21
Distance from venue: 5 km, 10 minutes by car
- h. Shenlong Hotel ★★★
Address: Emeishan Foguang South Road No. 102
Distance from venue: 4 km, 8 minutes by car

XVII. TRANSPORTATION - ARRIVAL

A. By Plane - to Chengdu Shuangliu Airport

- i. International gateway Chinese cities such as Beijing, Shanghai, Guangzhou, Xiamen, Qingdao, etc. have flights to Chengdu Shuangliu Airport. The Organizing Committee will have a reception desk at the airport to guide Teams to take the high-speed train to the Emeishan station, where there will also be a reception desk (travel from the airport to Emeishan station will be at the participant's expense).

B. By Train - to Emeishan City

- i. Large and medium-sized Chinese cities such as Xi'an, Chengdu, Kunming, etc. have trains to reach Emeishan, and the Organizing Committee will have a reception desk at the Emeishan railway station.

XVIII. FINANCIAL INFORMATION

A. Rates (per person per day)

- i. The participation fees include catering, accommodation, and local transportation. All Teams shall pay their participation fee in full to the 8th WKFC Organizing Committee via wire transfer upon final registration. All submitted fees are non-refundable.

Hotel Type	Single Occupancy Room	Double Occupancy Room
5 Stars	US\$ 95	US\$ 80
4 Stars	US\$ 75	US\$ 60
3 Stars	US\$ 65	US\$ 50

B. Payment Methods

- i. All Teams are required to complete payment in advance to the Organizing Committee by **May 10, 2019** through international remittance.
- ii. Teams that are unable to pay through international remittance should communicate with the Organizing Committee in advance to make arrangements. Otherwise, accreditation will not be issued.

C. Bank Information of Organizing Committee:

Bank Name	Agricultural Bank of China Chengdu Gaoxin Technology Industrial Development Zone Sub-Branch Banking DEPT.
Account Number	228088 14040001693
Account Name	Chengdu Ots Tourism Company Limited
SWIFT Code	ABOCCNBJ220
Bank Address	Chengdu Tianfu Avenue North No.20 Gaoxin International Square

* Note: Any service charges incurred by the bank for international wiring should be borne by the Teams.

XIX. PASSPORTS & VISA REQUIREMENTS

All 8th WKFC participants must hold a valid passport and should allow plenty of time for visa application and processing. To ensure as few complications during visa application and travel as possible, it is suggested that all participants' passports are valid for at least six (6) months following their final day of travel.

XX. RESPONSIBILITY OF NATIONAL FEDERATIONS

NFs are responsible for their officials, coaches, athletes, and observers adhering to the IWUF and WKFC principles and to all relevant rules established by the IWUF and Organizing Committee. NFs should ensure that their participants hold themselves to the highest standards in all their actions during the event.

A. Fundamental Principles

All NFs participating in the 8th WKFC must observe and respect the authority of the IWUF constitution, rules, regulations, and representatives. Individuals deemed to have acted against the IWUF, its principles, or purpose may be subject to suspension or expulsion from the event and/or cancellation of their accreditation.

B. Attitude of Athletes

Athletes will compete under the responsibility of their NFs. NFs are fully responsible regarding the general attitude and comportment of their athletes.

C. Image of Athletes

Each NF is responsible for obtaining the rights for the IWUF to use its athletes' images at the discretion of the IWUF for promotional purposes in all forms.

D. Insurance

Each NF is solely responsible for insuring its athletes against injury and third part risk (public liability) during the period of the 8th WKFC. The IWUF and the Organizing Committee are not responsible in part or in whole for safety liability.

XXI. SEMINAR PROGRAMME

During the 8th World Kungfu Championships there will be seminars across a wide range of disciplines led by renowned experts. The content will feature lectures and workshops on various wushu topics, with a focus on traditional styles. All participants including athletes, coaches, judges, officials, and spectators are welcome to attend this event. More information will be provided in due course.

XXII. APPENDIX

1. Wavier of Liabilities

APPENDIX 1

Wavier of Liabilities

Federation:		<div style="border: 1px dashed black; padding: 20px; text-align: center;"> Photo Passport Size </div>
Name of Participant:		
Name of Parent/ Legal Guardian(if applicable):		
Date of Birth:		
Age:		
Nationality:		
Gender:		
Passport No.:		
Role of Participants: <input type="checkbox"/> Athlete <input type="checkbox"/> Team Manager <input type="checkbox"/> Coach <input type="checkbox"/> Doctor <input type="checkbox"/> Observer		

I, the undersigned, knowingly and without duress, do voluntarily submit my Entry to the 8th World Kungfu Championships (WKFC). The 8th World Kungfu Championships is hosted by International Wushu Federation (IWUF) and organized by Chinese Wushu Association and City of Emeishan, hereafter Chinese Wushu Association and City of Emeishan collectively refers as "Organizing Committee". In consideration of the IWUF and Organizing Committee accepting my application, I hereby assume all risk of physical and mental injuries, disabilities and losses which may result from or in connection with my participation in the 8thWKFC. Acting for myself, heirs, personal officers, agents, representatives and assignees, I do hereby release the IWUF and Organizing Committee, its officers, agents, representatives, volunteers, judges and referees and other related members from all claims, actions, suits, and controversies at law or in equity by reason of any matter, cause or thing whatsoever that I may sustain as a result of or in connection with my participation in the 8thWKFC. I fully understand that all medical attention or treatment afforded to me by the IWUF and Organizing Committee, its officers, medical personnel, representatives, volunteers, and all other related members will be of the first aid type only, and hereby release the IWUF and Organizing Committee its officers, representatives, volunteers, and all other related members from any liability for such aid. I understand it is my obligation to obtain my own medical coverage.

I agree to abide by and follow the Rules established by the IWUF and Organizing Committee. I agree that I will conduct myself in a professional and courteous manner at all times and to be subject to penalties and sanctions for violations related thereto. I understand that my protest must be conducted in accordance with the Rules of Arbitration. I agree that my performance, attendance, and participation at the 8thWKFC may be filmed or otherwise recorded or released or telecast live. I consent to allow the IWUF and Organizing Committee use of my name, address, voices, poses, pictures and biographical data concerning full or parts, in any form or language, with or without other material, throughout the world, without limitation, for television, radio, video, theatrical medium picture, or any other medium by any devices now known or hereafter devised and I do hereby waive any compensation in regard thereof as well as any future rights to the aforementioned.

I have read and fully understand the waiver listed above.

Signature of Participant	Signature of Parent/ Legal Guardian	Date